

# Brake fluid reservoir filling instructions for racing use

Thank you for purchasing this Moto-Master performance product. Please read these instructions carefully before attempting installation. \*

**This filling instruction should only be carried out with a new set of brake pads and with the brake disc within the tolerable wear limits.**

## Step 1

Remove the lid (1), ring (2) and bellows (3) from the reservoir (4).  
Fill the reservoir (4) with new DOT4 / DOT5.1 brake fluid.  
Actuate the brake lever (5) and keep the brake fluid above the MIN-mark on the reservoir (4).  
Bleed the brake system of all air using the bleed valves on brake caliper and master cylinder (6).

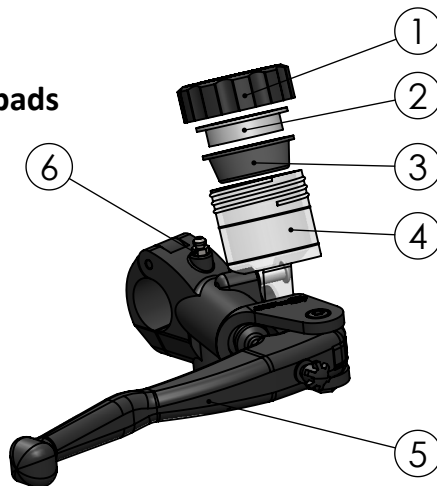

## Step 2

Remove the brake caliper (8) from the bike.  
Pump the brake caliper cylinders (7) out of the caliper (8) by actuating the brake lever (5) until the brake pads (9) touch each other.  
Make sure the brake fluid level does not drop below the MIN-mark on the reservoir (4).

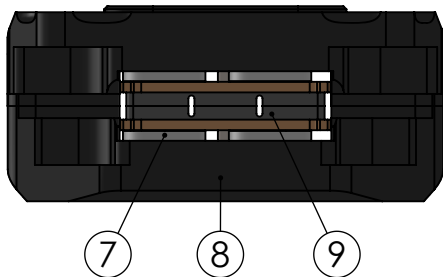

## Step 3

Fill the reservoir with brake fluid up to the MAX-mark on the reservoir (4).  
Insert the **fold out bellow (10)** and ring (2) into the expansion reservoir (4), so there is no air between the bellow (10) and the brake fluid.

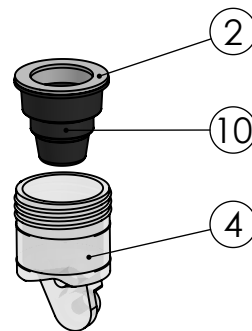

## Step 4

Close the reservoir (4) with the lid (1).  
The bellow (10) should still be fold out with no air between the bellow and the brake fluid.

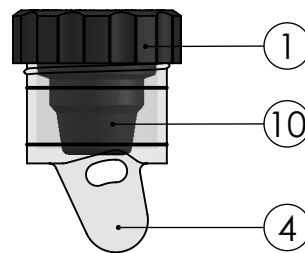

## Step 5

Push the brake pads (9) and caliper cylinders (7) back into the brake caliper (8).  
The bellow (10) will be pressed together into the folded state (3) by the brake fluid that enters the reservoir (4).  
Mount the brake caliper (8) in the correct position on the bike.

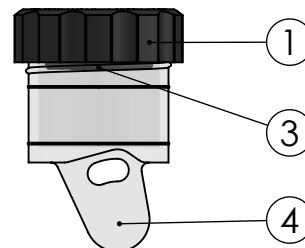

\*Consult a certified dealer or professional mechanic if you are not fully qualified in motorcycle maintenance. Moto-Master cannot be held responsible for any damage or injury caused by incorrect product mounting, disregarding specifications and these instructions, or product mounting by an unqualified third party.



For more info, check:

[WWW.MOTO-MASTER.COM](http://WWW.MOTO-MASTER.COM)