

## RMC-R Radial master cylinder mounting instructions

Thank you for purchasing this Moto-Master performance product. Please read these instructions carefully before attempting installation. \*

### Step 1

Remove existing master cylinder with brake line from the handle bar. Clean master cylinder mounting surface on the handle bar.

Avoid spilling brake fluid.

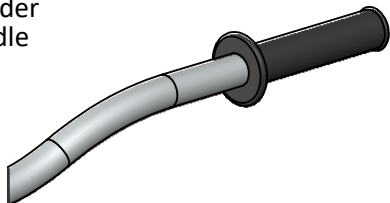

### Step 2

Install the Moto-Master Radial Master Cylinder and make sure the bleeder screw is positioned at the highest point. Level the brake fluid reservoir horizontally and fasten the 2 bolts of the master cylinder clamp. The final angle of the master cylinder can be adjusted after bleeding.

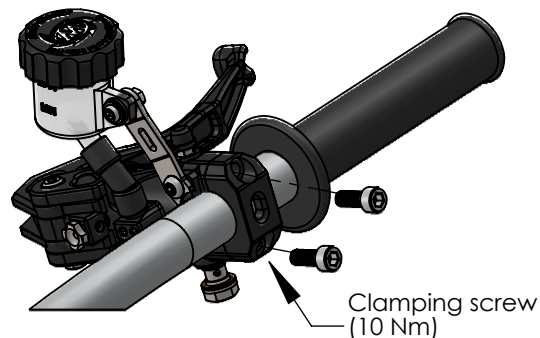

### Step 3

Install brake line as depicted; Using the banjo bolt and placing the brake line fitting in between two copper washer rings. (Use a brake light switch banjo bolt if required)

Torque tighten the banjo bolt at 20Nm.

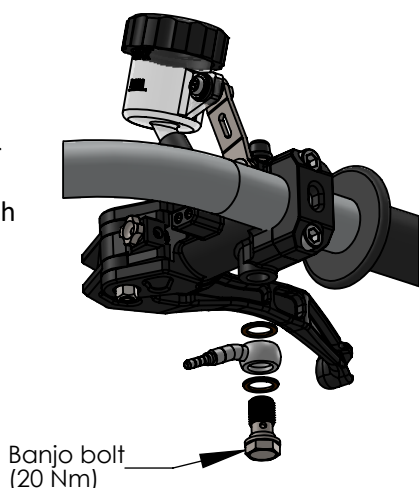

### Step 4

Check the front brake pads for wear and replace if necessary.

Remove the reservoir cap and bellows. Fill the reservoir with DOT 4 or DOT 5.1 brake fluid from a sealed container.

Actuate the brake lever and keep the fluid level between the MIN and MAX-mark on the reservoir. Thoroughly bleed the brake system of all air using the bleeder screw on the brake caliper and on the master cylinder.

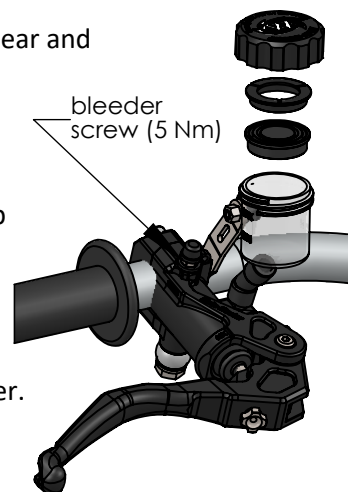

### Step 5

Adjust the position and angle of the master cylinder. Set the desired free stroke and then adjust the lever position with the reach screw to your preference. Fine-tuning of the Master Cylinder:

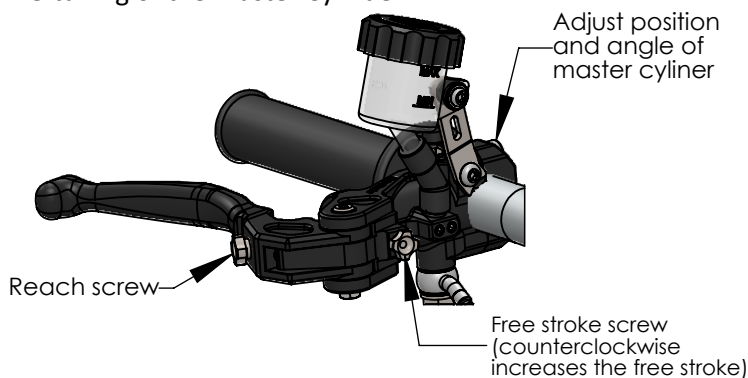

### Spare parts and revision kits

Moto-Master offers spare parts and a revision kit to keep your Master Cylinder in perfect working condition. Check the product numbers of the available spare parts below;

- 213101 RMC-R Lever
- 213102 RMC-R Pressure pin
- 213103 RMC-R Bleeder screw and dust cap
- 213104 RMC-R Reservoir cap
- 213105 RMC-R Revision kit 12mm
- 213107 RMC-R Remote reservoir kit
- 213017 Single banjo bolt (incl. 2x copper washer)
- 213007 Double banjo bolt (incl. 3x copper washer)
- 213099 Banjo bolt with brake light switch

### Info

Never use Dot 5 brake fluid or mineral oil, the brake system is not designed for it.

Avoid contact between brake fluid and painted parts.

Check for free travel of the brake lever, pressure builds up in the brake system if there is no free travel. This can result in failure due to overheating.

Check the brake fluid level of the reservoir before every ride. If the brake fluid level drops below the MIN-mark there can be a leak in the brake system, or the brake pads and/or disc are worn down. Stop riding and inspect the complete brake system.

Change the brake fluid regularly according to your service schedule. Use only brake fluid from a sealed container.

\*Consult a certified dealer or professional mechanic if you are not fully qualified in motorcycle maintenance. Moto-Master cannot be held responsible for any damage or injury caused by incorrect product mounting, disregarding specifications and these instructions, or product mounting by an unqualified third party.



For more info, check:

[WWW.MOTO-MASTER.COM](http://WWW.MOTO-MASTER.COM)