

# Supermoto Racing caliper adapter mounting instructions

This manual applies to article: 211022 - 211098

## Front Fork up to and including 2014

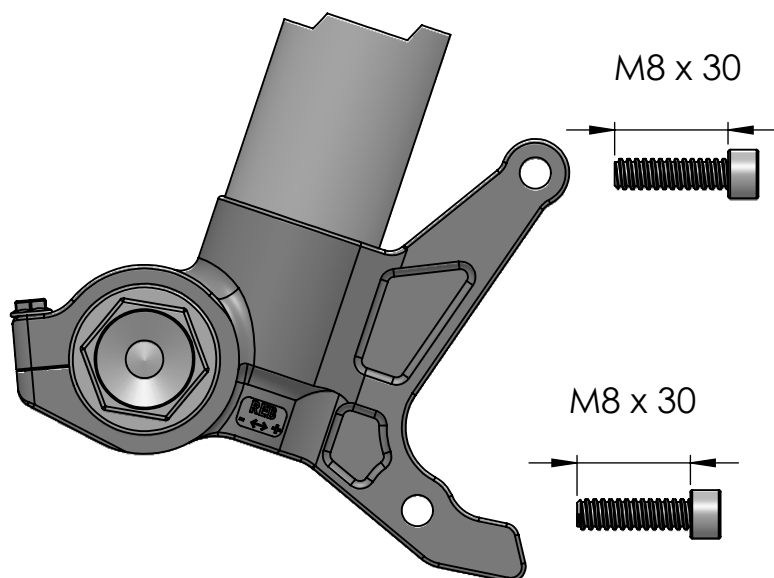

Use the included Moto-Master M8 x 30 mm bolts to mount the caliper adapter bracket.

Do **not** use your motorcycle's original (OEM) M8 x 35 mm bolts.

## Front Fork from 2015 - and up

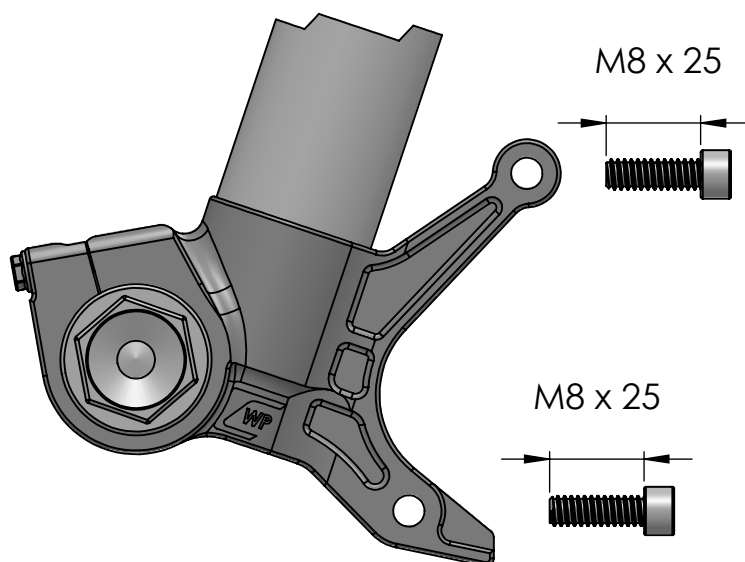

Use the included Moto-Master M8 x 25 mm bolts to mount the caliper adapter bracket.

Do **not** use your motorcycle's original (OEM) M8 x 30 mm bolts.

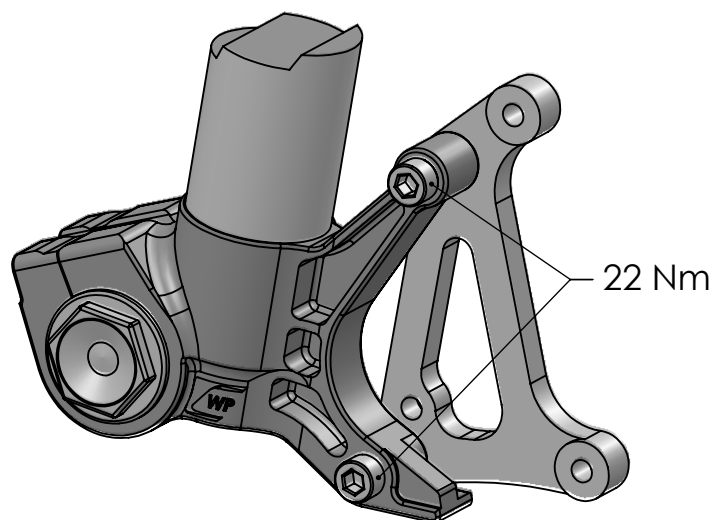

For more info, check:

[WWW.MOTO-MASTER.COM/DOWNLOADS](http://WWW.MOTO-MASTER.COM/DOWNLOADS)